

Issue 23

In this issue, assemble the Propeller Shaft. The Propeller Shaft transmits engine power, via the transmission, to the differential gears of the Rear Axle. It consists of two shafts connected by Universal Joints.



Assemble the Propeller Shaft

※ In this guide "Left" or "(L)", and "Right" or "(R)", refer to the direction as viewed from the driver's seat.

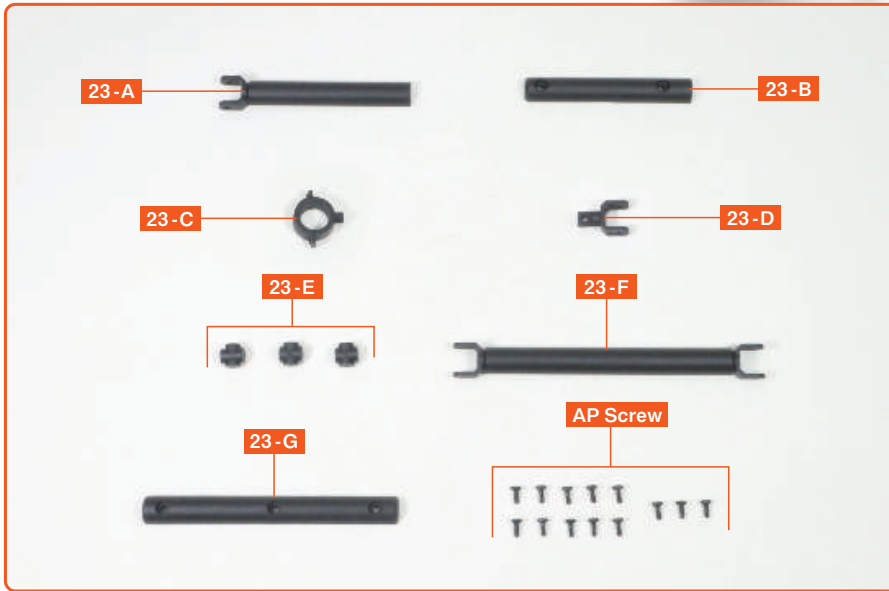

23-A Front Propeller Shaft (1)

23-B Front Propeller Shaft (2)

23-C Centre Support Bearing

23-D Joint Yoke

23-E Spider×3

23-F Rear Propeller Shaft (1)

23-G Rear Propeller Shaft (2)

AP Screw (1.7×4 mm) ×13+Spare

View the follow-along video



※ Due to the model's design, the shapes of some parts may differ from those of the real vehicle.

step 1 Assemble the Front Propeller Shaft

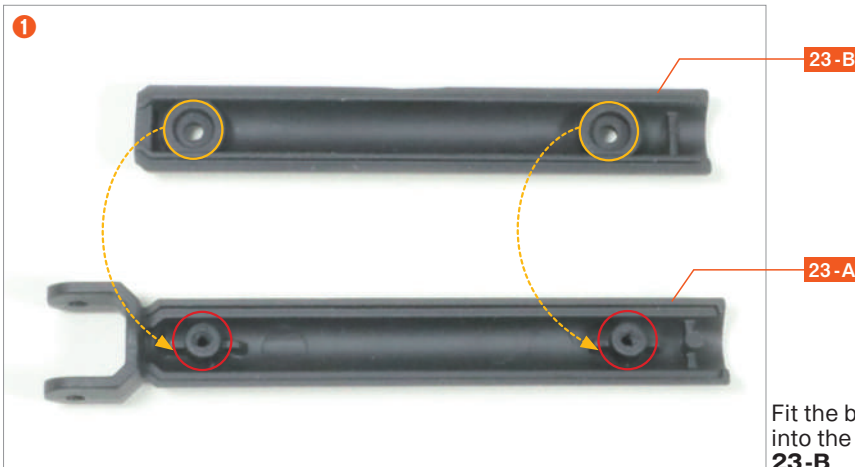

Fit the bosses on **Front Propeller Shaft (1) 23-A** into the recesses on **Front Propeller Shaft (2) 23-B**.

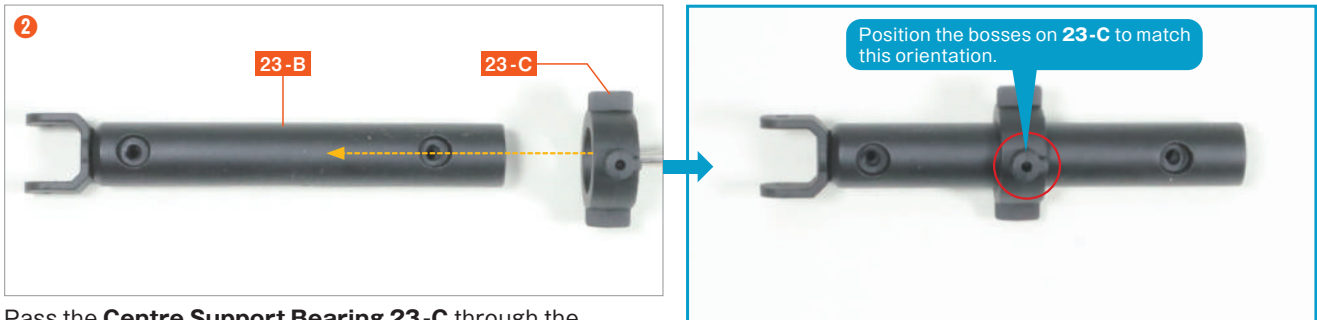

Pass the **Centre Support Bearing 23-C** through the assembly from step 1.

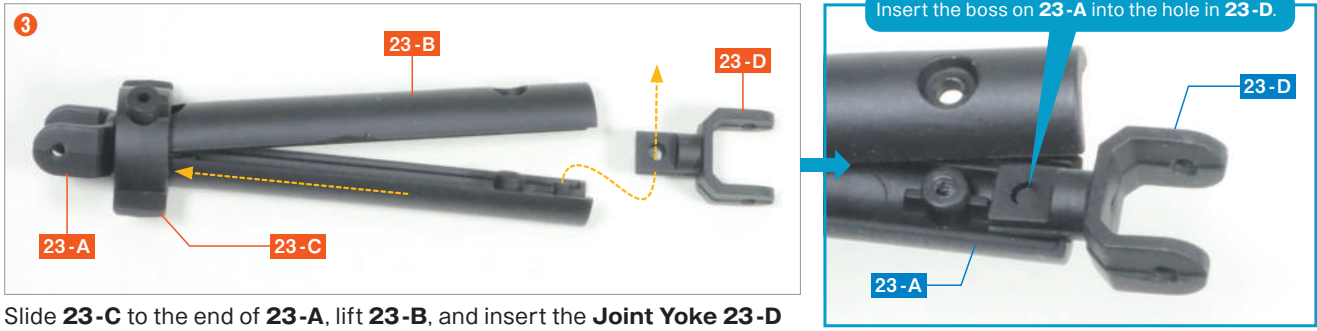

Slide **23-C** to the end of **23-A**, lift **23-B**, and insert the **Joint Yoke 23-D** between them.

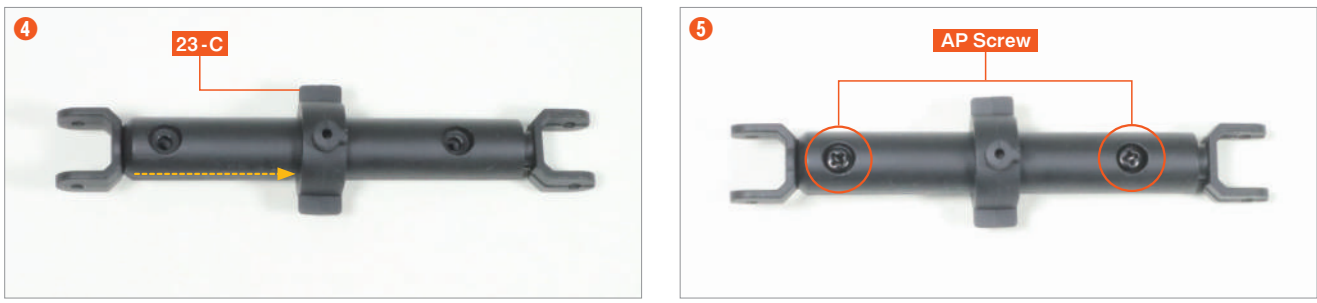

Refit **23-A** and **23-B**, then slide **23-C** to the centre.

Secure at two points with **AP Screws**.

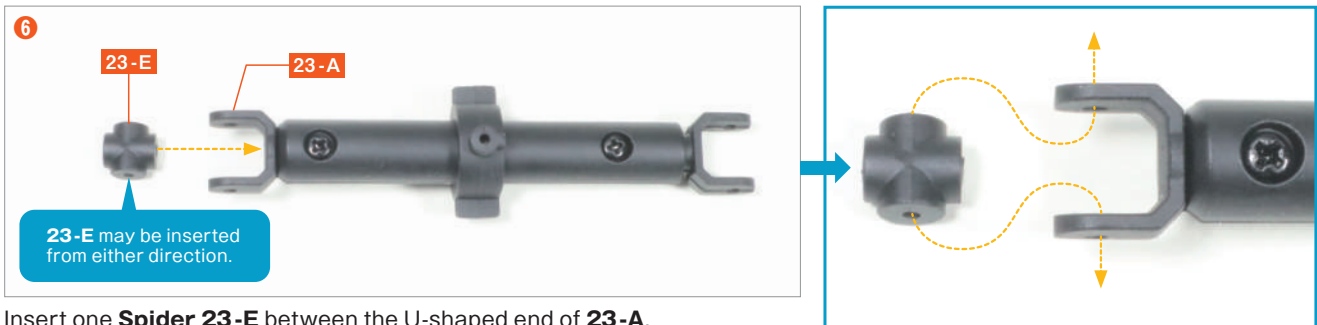

Insert one **Spider 23-E** between the U-shaped end of **23-A**.

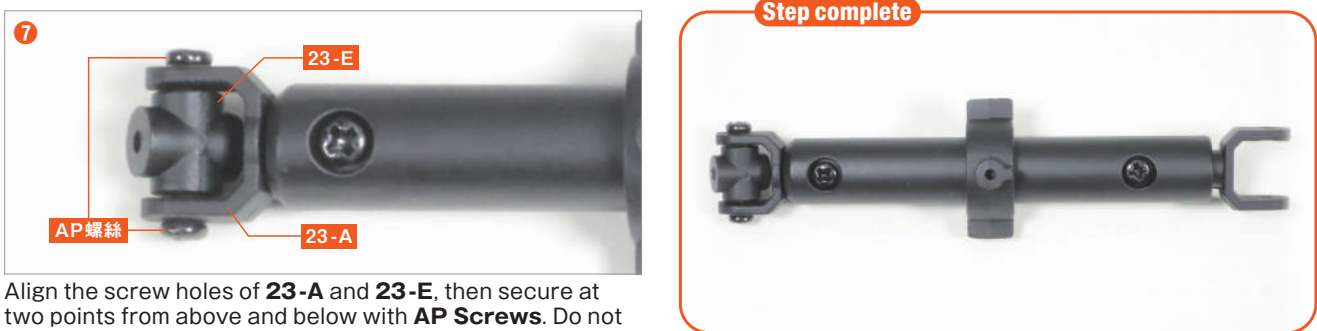

Align the screw holes of **23-A** and **23-E**, then secure at two points from above and below with **AP Screws**. Do not overtighten; ensure **23-E** can move freely.

step 2 Assemble the Rear Propeller Shaft

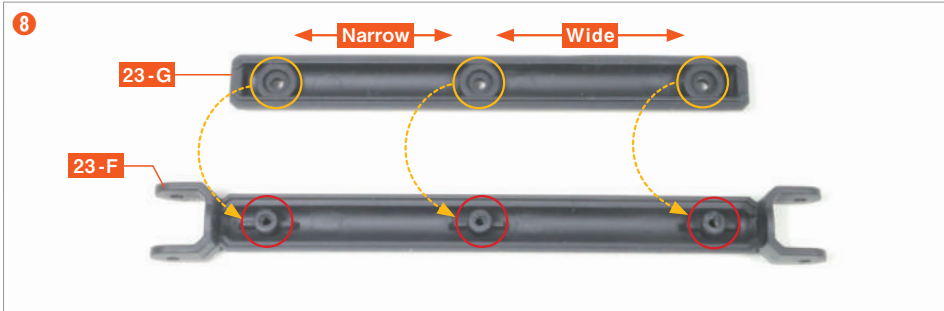

Fit the bosses on **Rear Propeller Shaft (1) 23-F** into the recesses on **Rear Propeller Shaft (2) 23-G**.

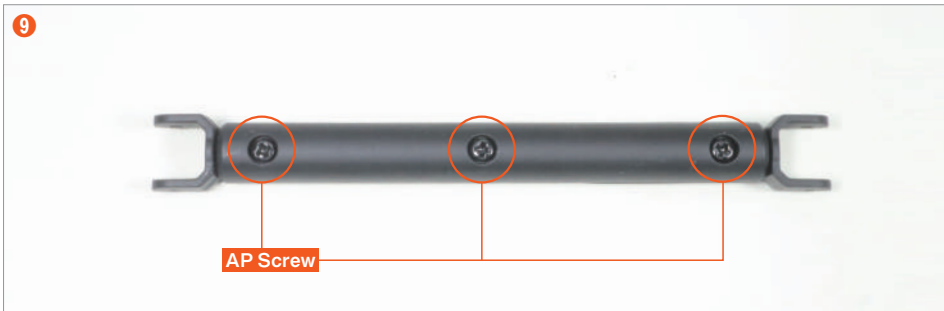

Secure at three points with **AP Screws**.



Insert one **23-E** between the Ushaped ends on each side of **23-F**.

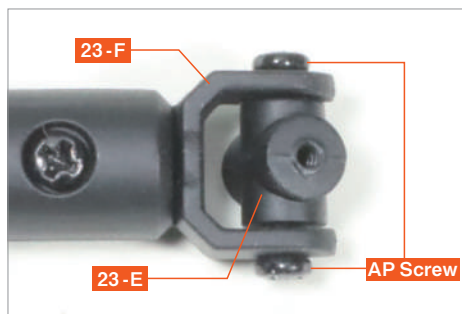
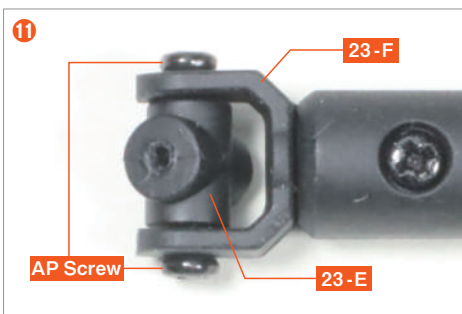

Align the screw holes of **23-F** and **23-E**, then secure each at two points with **AP Screws**. Do not overtighten; ensure **23-E** can move freely.

Step complete



step 3 Connect the Front Propeller Shaft and Rear Propeller Shaft

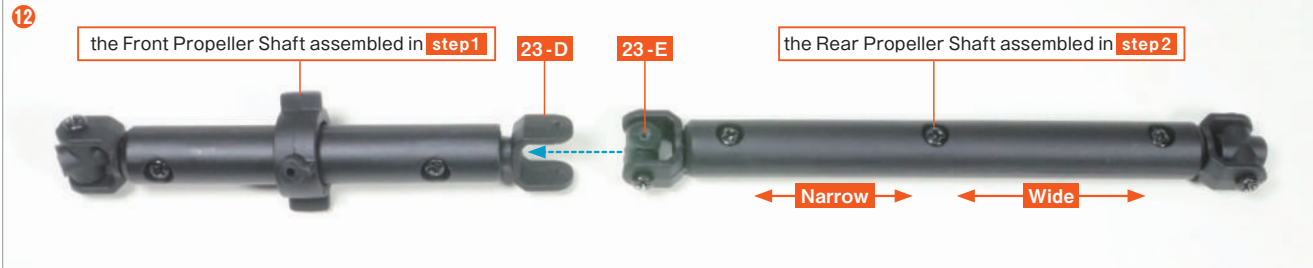

Take the **Front Propeller Shaft assembled in Step 1** and insert **23-E** on the Rear Propeller Shaft assembled in Step 2 between the U-shaped ends of **23-D**.



Align the screw holes of **23-D** and **23-E**, then secure at two points from above and below with **AP Screws**.

Complete

The assembly for Issue 23 is complete. Rotate the front and rear Propeller Shafts with their axes offset to observe the characteristics of the Universal Joint. In Issue 24, begin assembling the Rear Axle.

